

SWITCHING TRANSFORMER

SIZE ETD29

4 OUTPUT:5+ 12v/5+ 12v

PIN 4 Removed
PCB Hole Diameter=1.3mm

Part NO.	Output Power Maximum	Windings				Inductance (+/-10%)	Ambient Temperature	Frequency
			Pins	Voltage	Current Maximum			
SR-ED2901	18w	Pri	5-7	185-265Vrms	3.0Apeak	500 μ H	< 50°C	60 or 132KHZ
		Aux	3-2	7-14.5Vdc	0.5Adc			
		S1	12-13	3.3-7Vdc	4Adc			
		S2	11-13	8-16.5Vdc	2.5Adc			
		S3	9-10	3.3Vdc	4Adc			
		S4	8-10	8.5-16.5Vdc	2.5Adc			

NOTE:S1/S3 or S2/S4 can be connected in series or in parallel

OUTLINE DIMENSIONS

SCHEMATIC

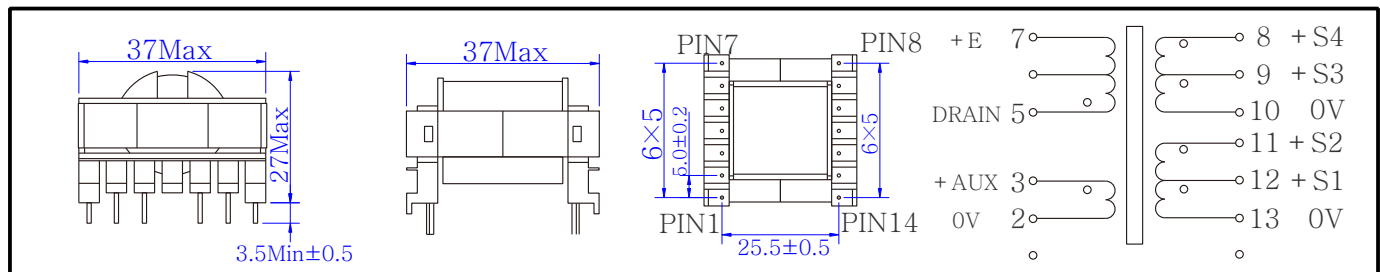

SIZE ETD34

4 OUTPUT:5+ 12v/5+ 12v

PIN 4 Removed
PCB Hole Diameter=1.5mm

Part NO.	Output Power Maximum	Windings				Inductance (+/-10%)	Ambient Temperature	Frequency
			Pins	Voltage	Current Maximum			
SR-ED3401	90w	Pri	5-7	185-265Vrms	2.8Apeak	500 μ H	< 50 °C	132KHZ
		Aux	3-2	7-14Vdc	0.5Adc			
		S1	12-13	3.3-6.5Vdc	5Adc			
		S2	11-13	8-17Vdc	3Adc			
		S3	9-10	3.3-6.5Vdc	5Adc			
		S4	8-10	8.5-17Vdc	3Adc			

OUTLINE DIMENSIONS

SCHEMATIC

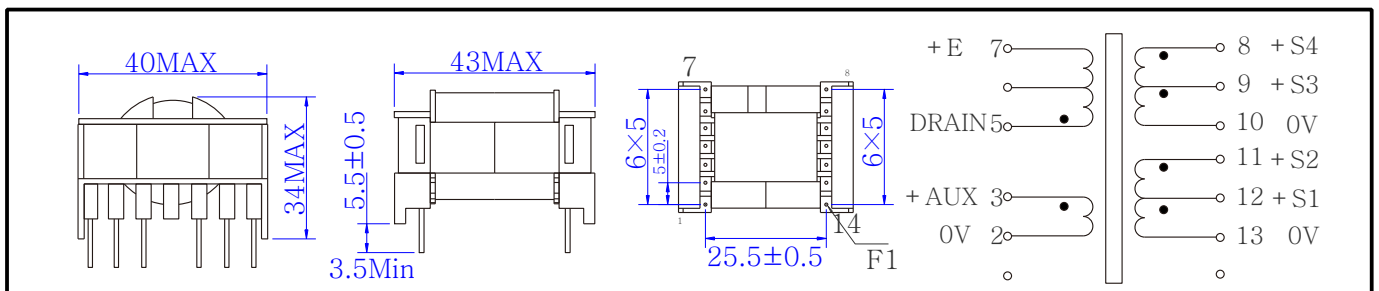

PIN 4 Removed PCB Hole Diameter=1.5mm